

Tower 1
第1座
15/F - 21/F and 23/F Floor Plan
15樓至21樓及23樓樓面平面圖

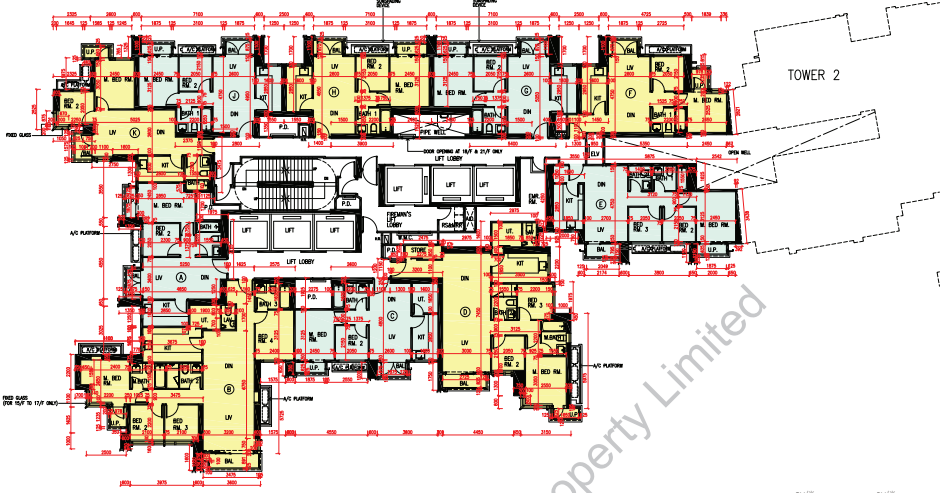

Scale: 0M/1M
比例: 1:1000

Tower 座數	Floor 樓層	Units 單位									
		A	B	C	D	E	F	G	H	J	K
Tower 1 第1座	15/F - 20/F 15樓至20樓	150, 175, 180	150, 175	150, 175, 180	150, 200, 250	150, 200	150, 200	150, 200	150, 200	150, 175, 250	150, 175, 250
		3110	3110	3110	3110	3110	3110	3110	3110	3110	3110

The internal areas of the residential properties on the upper floors will generally be slightly larger than those on the lower floors because of the reducing thickness of the structural walls on the upper floors.
因住宅物業的高層樓層的結構牆的厚度減薄，較高樓層的內部面積較大。

- Notes:
- The dimensions in the floor plans are all structural dimensions in millimeter.
 - (i) The restriction on the minimum number of residential units (as referred to in Special Condition No. (14) (b)(i)(ii)(iii) of the Land Grant) in Phase VI, 1.633.
 - (ii) Special Condition No. (14) (k) of the Land Grant stipulates that except with the prior written consent of the Director of Lands ("the Director"), the Grantee shall not carry out or permit or suffer to be carried out any works in connection with any residential flat erected or to be erected on Site C1, Site G, Site H, Site I, Site J, Site N and Site O, including but not limited to demolition or alteration of any partition wall or any floor or roof slab or any partition structure, which shall result in such flat being internally linked to and accessible from any adjoining or adjacent residential flat erected or to be erected on Site C1, Site G, Site H, Site I, Site J, Site N and Site O. The decision of the Director as to what constitutes works resulting in a flat being internally linked to and accessible from any adjoining or adjacent residential flat shall be final and binding on the Grantee.
 - (iii) Clause 15 of the Third Schedule to the approved form of Sub-Deed of Mutual Covenant and Management Agreement stipulates that: "The Manager shall deposit in the management office of Phase VI the record provided by the Director of the information relating to the consent given under Special Condition No.14(k) of the Government Grant for inspection by all Owners of Phase VI free of costs and for taking copies at their own expense and on payment of a reasonable charge, all charges received to be credited to the Special Fund for Phase VI."
 - (iv) The total number of residential units provided in the Phase: 2,392

- 備註:
- 樓面平面圖所列之尺寸為以毫米標示之建築結構尺寸。
 - (i) 第16(b)(i)(ii)(iii)條批地文件特別條款中對於第VI期中住宅單位的最少數目的限制: 1,633
 - (ii) 第16(k)條批地文件特別條款規定，除非獲地政總署署長（「署長」）事先書面同意，業主不得進行或准許或容許與已或將會建於地段C1、地段G、地段H、地段I、地段J及地段N的任何住宅單位有關的任何工程（包括但不限於拆除或改變任何分隔牆、任何地板或天花或任何隔牆結構）而使該單位可由內部連接及可由任何已或將會建於地段C1、地段G、地段H、地段I、地段J及地段N的毗連或鄰近住宅單位進入，對於該項工程可從一個單位可由內部連接及可由任何毗連或鄰近住宅單位進入之工程，署長之決定應為最終並對業主具有約束力。
 - (iii) 已批核的副公契約及管理協議中第三附錄第15條規定：「經理人需於第VI期管理處存放由署長提供、關於第16(k)條批地文件特別條款所提出的資料紀錄，以供所有第VI期業主免費查閱，及在支付合理費用後，自費印取該等資料的副本，而該等費用將會存入第VI期之特別基金。」
 - (iv) 期數所提供的住宅單位總數：2,392

Tower 座數	Floor 樓層	Units 單位									
		A	B	C	D	E	F	G	H	J	K
Tower 1 第1座	21/F 21樓	150, 175, 180	150, 175	150, 175, 180	150, 200, 250	150, 200	150, 200	150, 200	150, 200, 300	150, 200, 300	150, 175, 250
		3110, 3410	3110, 3210, 3460	3110, 3210, 3410	3110, 3210, 3460	3110, 3210, 3410	3110, 3210, 3410	3110, 3210, 3510	3110, 3210, 3410	3110, 3210, 3510	3110, 3410

The internal areas of the residential properties on the upper floors will generally be slightly larger than those on the lower floors because of the reducing thickness of the structural walls on the upper floors.
因住宅物業的高層樓層的結構牆的厚度減薄，較高樓層的內部面積較大。

- Notes:
- The dimensions in the floor plans are all structural dimensions in millimeter.
 - (i) The restriction on the minimum number of residential units (as referred to in Special Condition No. (14) (b)(i)(ii)(iii) of the Land Grant) in Phase VI, 1.633.
 - (ii) Special Condition No. (14) (k) of the Land Grant stipulates that except with the prior written consent of the Director of Lands ("the Director"), the Grantee shall not carry out or permit or suffer to be carried out any works in connection with any residential flat erected or to be erected on Site C1, Site G, Site H, Site I, Site J, Site N and Site O, including but not limited to demolition or alteration of any partition wall or any floor or roof slab or any partition structure, which shall result in such flat being internally linked to and accessible from any adjoining or adjacent residential flat erected or to be erected on Site C1, Site G, Site H, Site I, Site J, Site N and Site O. The decision of the Director as to what constitutes works resulting in a flat being internally linked to and accessible from any adjoining or adjacent residential flat shall be final and binding on the Grantee.
 - (iii) Clause 15 of the Third Schedule to the approved form of Sub-Deed of Mutual Covenant and Management Agreement stipulates that: "The Manager shall deposit in the management office of Phase VI the record provided by the Director of the information relating to the consent given under Special Condition No.14(k) of the Government Grant for inspection by all Owners of Phase VI free of costs and for taking copies at their own expense and on payment of a reasonable charge, all charges received to be credited to the Special Fund for Phase VI."
 - (iv) The total number of residential units provided in the Phase: 2,392

- 備註:
- 樓面平面圖所列之尺寸為以毫米標示之建築結構尺寸。
 - (i) 第16(b)(i)(ii)(iii)條批地文件特別條款中對於第VI期中住宅單位的最少數目的限制: 1,633
 - (ii) 第16(k)條批地文件特別條款規定，除非獲地政總署署長（「署長」）事先書面同意，業主不得進行或准許或容許與已或將會建於地段C1、地段G、地段H、地段I、地段J及地段N的任何住宅單位有關的任何工程（包括但不限於拆除或改變任何分隔牆、任何地板或天花或任何隔牆結構）而使該單位可由內部連接及可由任何已或將會建於地段C1、地段G、地段H、地段I、地段J及地段N的毗連或鄰近住宅單位進入，對於該項工程可從一個單位可由內部連接及可由任何毗連或鄰近住宅單位進入之工程，署長之決定應為最終並對業主具有約束力。
 - (iii) 已批核的副公契約及管理協議中第三附錄第15條規定：「經理人需於第VI期管理處存放由署長提供、關於第16(k)條批地文件特別條款所提出的資料紀錄，以供所有第VI期業主免費查閱，及在支付合理費用後，自費印取該等資料的副本，而該等費用將會存入第VI期之特別基金。」
 - (iv) 期數所提供的住宅單位總數：2,392

Tower 座數	Floor 樓層	Units 單位									
		A	B	C	D	E	F	G	H	J	K
Tower 1 第1座	23/F 23樓	150, 175, 180	150, 175	150, 175, 180	150, 200, 250	150, 200	150, 200	150, 200	150, 200	150, 175, 250	150, 175, 250
		3110	3110	3110	3110	3110	3110	3110	3110	3110	3110

The internal areas of the residential properties on the upper floors will generally be slightly larger than those on the lower floors because of the reducing thickness of the structural walls on the upper floors.
因住宅物業的高層樓層的結構牆的厚度減薄，較高樓層的內部面積較大。

- Notes:
- The dimensions in the floor plans are all structural dimensions in millimeter.
 - (i) The restriction on the minimum number of residential units (as referred to in Special Condition No. (14) (b)(i)(ii)(iii) of the Land Grant) in Phase VI, 1.633.
 - (ii) Special Condition No. (14) (k) of the Land Grant stipulates that except with the prior written consent of the Director of Lands ("the Director"), the Grantee shall not carry out or permit or suffer to be carried out any works in connection with any residential flat erected or to be erected on Site C1, Site G, Site H, Site I, Site J, Site N and Site O, including but not limited to demolition or alteration of any partition wall or any floor or roof slab or any partition structure, which shall result in such flat being internally linked to and accessible from any adjoining or adjacent residential flat erected or to be erected on Site C1, Site G, Site H, Site I, Site J, Site N and Site O. The decision of the Director as to what constitutes works resulting in a flat being internally linked to and accessible from any adjoining or adjacent residential flat shall be final and binding on the Grantee.
 - (iii) Clause 15 of the Third Schedule to the approved form of Sub-Deed of Mutual Covenant and Management Agreement stipulates that: "The Manager shall deposit in the management office of Phase VI the record provided by the Director of the information relating to the consent given under Special Condition No.14(k) of the Government Grant for inspection by all Owners of Phase VI free of costs and for taking copies at their own expense and on payment of a reasonable charge, all charges received to be credited to the Special Fund for Phase VI."
 - (iv) The total number of residential units provided in the Phase: 2,392

- 備註:
- 樓面平面圖所列之尺寸為以毫米標示之建築結構尺寸。
 - (i) 第16(b)(i)(ii)(iii)條批地文件特別條款中對於第VI期中住宅單位的最少數目的限制: 1,633
 - (ii) 第16(k)條批地文件特別條款規定，除非獲地政總署署長（「署長」）事先書面同意，業主不得進行或准許或容許與已或將會建於地段C1、地段G、地段H、地段I、地段J及地段N的任何住宅單位有關的任何工程（包括但不限於拆除或改變任何分隔牆、任何地板或天花或任何隔牆結構）而使該單位可由內部連接及可由任何已或將會建於地段C1、地段G、地段H、地段I、地段J及地段N的毗連或鄰近住宅單位進入，對於該項工程可從一個單位可由內部連接及可由任何毗連或鄰近住宅單位進入之工程，署長之決定應為最終並對業主具有約束力。
 - (iii) 已批核的副公契約及管理協議中第三附錄第15條規定：「經理人需於第VI期管理處存放由署長提供、關於第16(k)條批地文件特別條款所提出的資料紀錄，以供所有第VI期業主免費查閱，及在支付合理費用後，自費印取該等資料的副本，而該等費用將會存入第VI期之特別基金。」
 - (iv) 期數所提供的住宅單位總數：2,392